

Elmo P30HD Document Camera – Instructions

1. Open the side drawer of the instructor's podium.
2. Lift the camera column. Simultaneously, the lamp column rises.

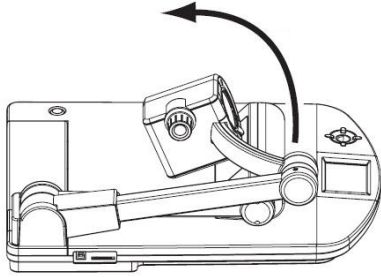

3. Turn the camera head.

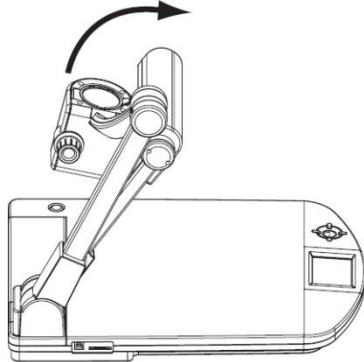

4. Move the lamp column and the lamp head to an appropriate position.

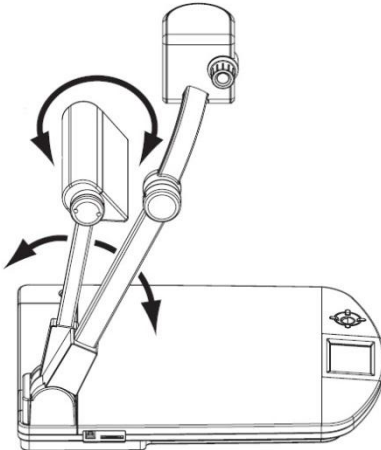

5. Select "Document Camera" as your source on the Creston panel.
6. Press "Controls" to the left of "Document Camera".

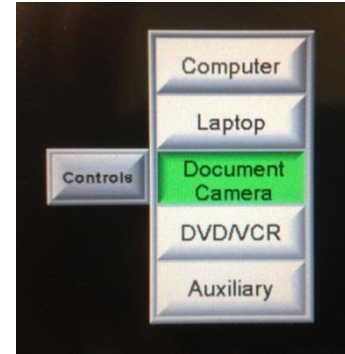

7. Turn on the lamp, adjust your zoom and focus here.
Do not press any buttons on the document camera.

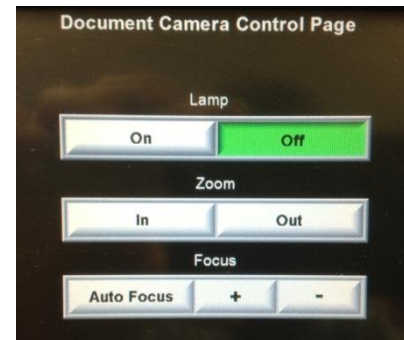

8. Turn the lamp head and lamp column and fold them on the stage.
Turn the camera head and camera column and fold them.

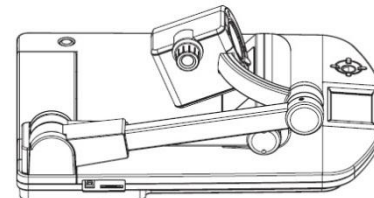

9. If you have any questions, or would like additional training,
please contact Jeremy Farkas at 410-704-4151 or jfarkas@towson.edu